

RHCA5039 series is suitable for products that need DC insulation resistance test on Line-FG, SG of a communications / signal line. Impulse current capacity is 2,000A 8/20 μ s.

Features

- Chip surge absorber for protection from indirect lighting surge, adaptable to high density surface mount technology
- Impulse current capacity 2,000A 8/20 μ s
- Small electrostatic capacity(Maximum 0.6pF)
- *Impulse Absorption Characteristics*

Impulse waveform 1.2/50 μ s-10,000V

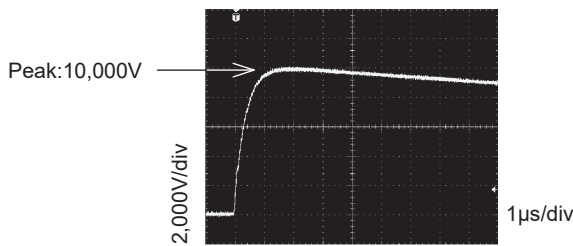

Safety Standard		File No.*
UL	:UL1449	E322107
cUL	:C22.2 No.269.5	
UL-EU	:EN61643-311 :IEC61643-311	

* File No. may be revised without notice. Please contact us at the time of your request for certifications.

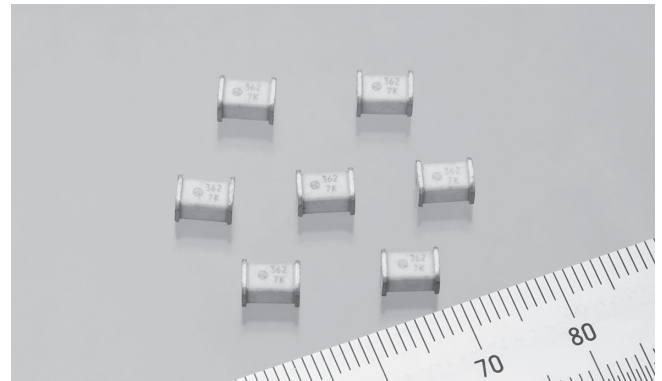

RHCA-242H53U
Impulse waveform

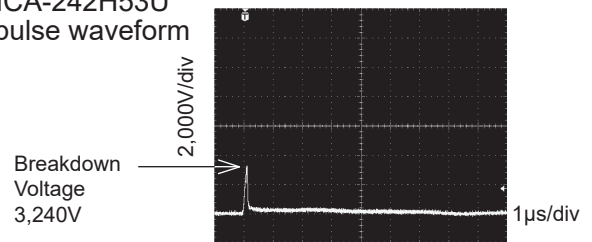

Electrical Specifications

•RHCA53 series

Safety Standard		Model Number	Impulse Sparkover Voltage 1.2/50 μ s (V) max.		Withstanding Voltage 50/60Hz	Insulation Resistance (M Ω) Min.	Capacitance 1MHz (pF) Max.	Impulse Life Test	Impulse Current Capacity	DC Breakdown Voltage (V)
UL1449 cUL	UL-EU		Applied Voltage	Specification						
○ ¹	○	RHCA-242H53U	5,000V	4,500V max.	AC1,000V-60sec AC1,200V-3sec	1,000(DC500V)	0.6	8/20 μ s 100A 300 times	8/20 μ s 2,000A	2,400 \pm 20% *3
○ ₂ ¹	○	RHCA-302H53U		4,700V max.	AC1,500V-60sec					3,000 \pm 20% *3
○ ₂ ¹	○	RHCA-362H53U		4,950V max.	AC1,500V-60sec AC1,800V-3sec					3,600 \pm 20% *3

•RHCA53(335) series

Safety Standard		Model Number	Impulse Sparkover Voltage 1.2/50 μ s (V) max.		Withstanding Voltage 50/60Hz	Insulation Resistance (M Ω) Min.	Capacitance 1MHz (pF) Max.	Impulse Life Test	Impulse Current Capacity	DC Breakdown Voltage (V)			
UL1449 cUL	UL-EU		Applied Voltage	Specification									
○ ₂ ¹	○	RHCA-102P53U(335)	5,000V	4,500V max.	AC1,000V 60s AC1,000V 60s AC1,200V 3s AC1,200V 60s	1,000(DC500V)	0.6	8/20 μ s 100A 300 times	8/20 μ s 3,500A	1,000 \pm 20%			
○ ₂ ¹	○	RHCA-102Q53U(335)								-	-	-	1,000 \pm 30%
○ ¹	○	RHCA-202H53U(335)								4,500V max.	AC1,000V 60s	2,000 \pm 20% *3	
○ ¹	○	RHCA-242H53U(335)								4,500V max.	AC1,000V 60s AC1,200V 3s	2,400 \pm 20% *3	
○ ¹	○	RHCA-272H53U(335)								4,500V max.	AC1,200V 60s	2,700 \pm 20% *3	
○ ₂ ¹	○	RHCA-302H53U(335)								4,700V max.	AC1,500V 60s	3,000 \pm 20% *3	
○ ₂ ¹	○	RHCA-362H53U(335)								4,950V max.	AC1,500V 60s AC1,800V 3s	3,600 \pm 20% *3	
○ ₂ ¹	○	RHCA-402H53U(335)								7,500V	7,450V max.	AC2,000V 60s	4,000 \pm 20% *3
○ ₂ ¹	○	RHCA-452H53U(335)								8,000V	7,950V max.	AC2,000V 60s	4,500 \pm 20% *3

*1 Rated voltage AC125V: Approved if it is connected to UL approved varistor (V1.0mA \geq 270V, D \geq 7mm).
*2 Rated voltage AC250V: Approved if it is connected to UL approved varistor (V1.0mA \geq 470V, D \geq 7mm). *3 Reference Value
Operating Temperature: -40~+85°C



• Dimensions

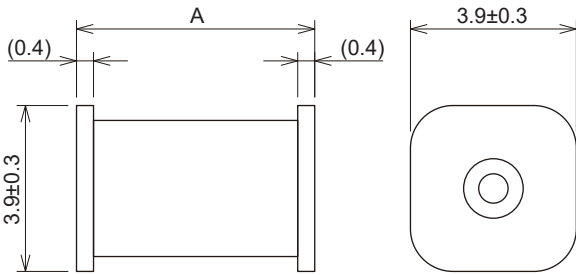

Model Number	A
RHCA5039	5.0±0.3
RHCA5039(335)	5.6±0.3

Unit: mm

• Description of marking

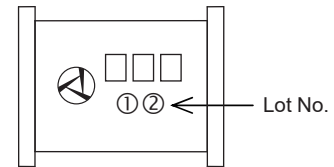

□□□..... DC Breakdown Voltage
eg.) RHCA-362H53U→362

[Lot No.] ①..... Identification of manufacture year
eg.) 2022→2

②..... Manufacture month (see below)

Month	1	2	3	4	5	6	7	8	9	10	11	12
Symbol	A	B	D	E	F	G	H	J	K	L	M	N

• Taping Dimensions

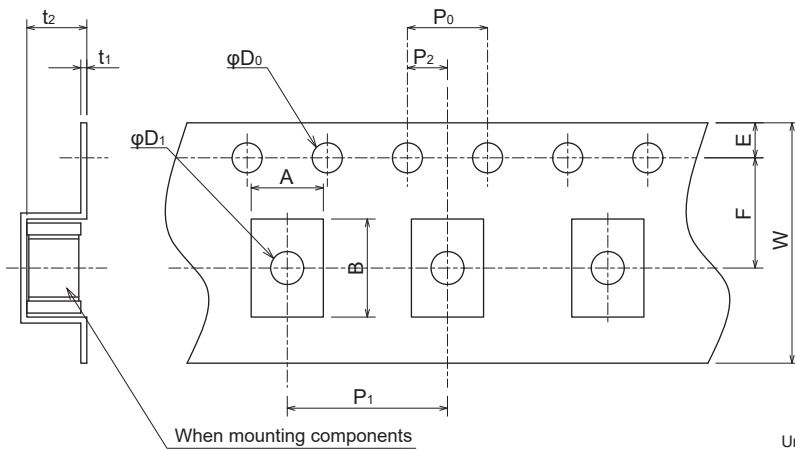

Dimensions (mm)		
	RHCA5039	RHCA5039(335)
A	4.5±0.3	4.2±0.3
B	5.6±0.3	6.0±0.3
W	12.0±0.3	12.0±0.3
F	5.5±0.1	5.5±0.1
E	1.75±0.1	1.75±0.2
P1	8.0±0.1	8.0±0.2
P2	2.0±0.1	2.0±0.1
P0	4.0±0.1	4.0±0.2
D0	φ 1.55±0.1	φ 1.55±0.1
D1	φ 1.5 min.	φ 1.7+0.2
t1	0.4±0.2	0.4±0.1
t2	4.3±0.2	4.2±0.2

Unit: mm

• Reel Dimensions (2,500pcs per one reel)

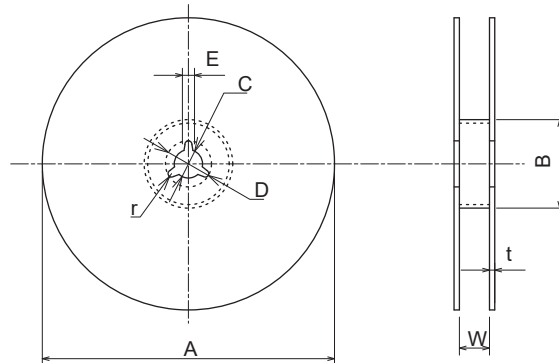

Dimensions (mm)	
A	φ 380±3
B	φ 80±2
C	φ 13.0±0.5
D	φ 21±1
E	2±1
W	13.5±2.0
t	2.0±0.5
r	1.0±0.2

Unit: mm

• Recommended Land Pattern (Typical value)

RHCA5039 Series

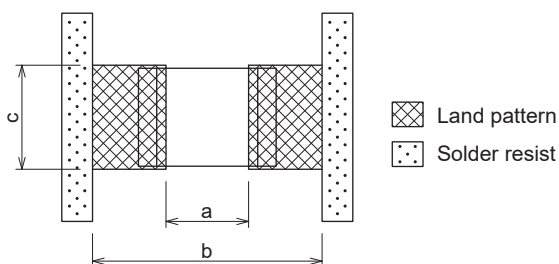

	Dimensions (mm)		
	a	b	c
Reflow Soldering	3.7	6.5	4.3

RHCA5039(335) Series

